



a CMC Property

859.291.9999

thefarm@cmcproperties.com

5061 Sandman Dr., Taylor Mill, KY 41015



Truly in a class by itself... The Farm at Taylor Mill is nestled in the rolling hills of Northern Kentucky. This beautiful property was once a prominent dairy farm. It is our goal at The Farm to provide our residents with modern day comforts and amenities without sacrificing the charm and character of this once rural area. Just off I-275, we're close to everything, yet worlds apart from a typical apartment community. **You're going to love it here at The Farm at Taylor Mill!**

Our Mission...

To simplify the lives of our customers in a cost effective way so they can have more time to pursue what is truly important to them.

- 2 Bdrm./2 Full Bath Apt. Homes
- Full Size Washer & Dryer Included
- Vaulted Ceilings with Skylights
- Cozy Woodburning Fireplaces
- Huge Walk-in Closets

- Tennis Court
- Sand Volleyball
- Fitness Center
- 2 Sparkling Swimming Pools
- Clubhouse for Rental
- Garage Available
- Walk to Shopping
- Farm Plots for "City Farmers"
- Pets are Welcome

See floor plans on reverse side.



For availability, visit us at
www.cmcproperties.com

Floorplans

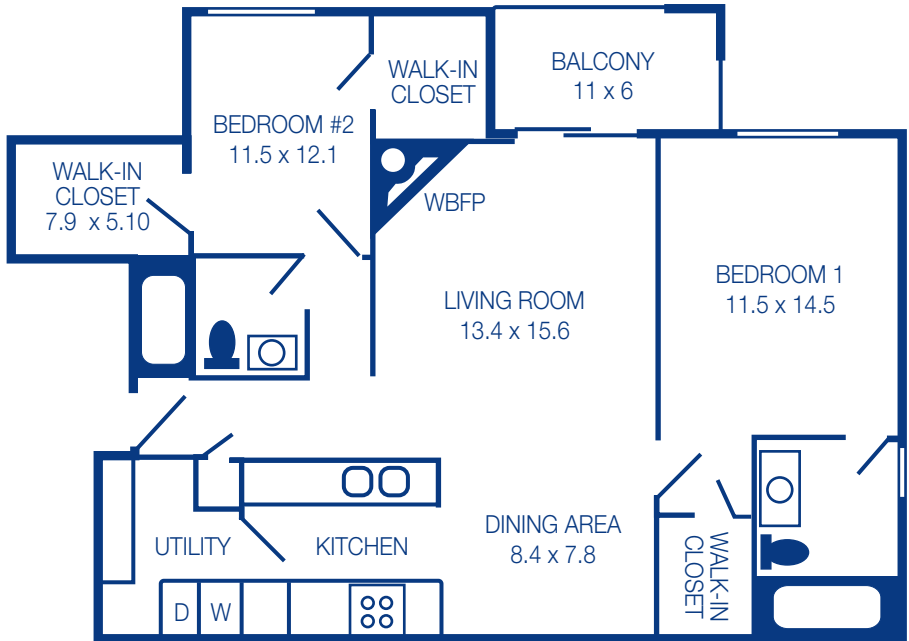

Two Bedroom

1,112 Sq. Ft.