

859.291.9999

5142 Old Taylor Mill Road, Taylor Mill, KY 41015

thefarmleasing@cmcproperties.com

www.cmcproperties.com

Truly in a class by itself...The Farm at Taylor Mill is nestled in the rolling hills of Northern Kentucky. This beautiful property was once a prominent dairy farm. It is our goal at The Farm to provide our residents with modern day comforts and amenities without sacrificing the charm and character of this once rural area. Just off I-275, we're close to everything, yet worlds apart from a typical apartment community. You're going to love it here at The Farm at Taylor Mill.

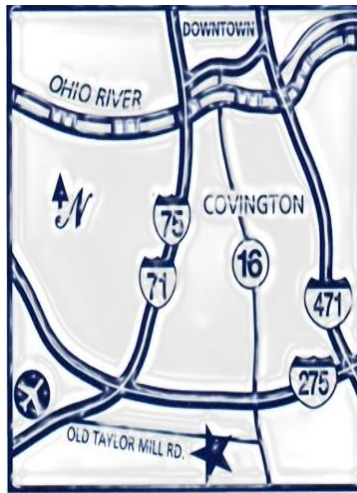

AMENITIES

- Granite Counter tops
- Stainless Steel Appliances
- Full Size Washer & Dryer Included
- Vaulted Ceilings with Skylights
- Cozy Wood burning Fireplaces
- Huge Walk-in Closets
- Tennis Court
- Sand Volleyball
- Fitness Center
- 2 Sparkling Swimming Pools
- Clubhouse for Rental
- Garage Available
- Walk to Shopping
- Farm Plots for "City Farmers"
- Pets Are Welcome

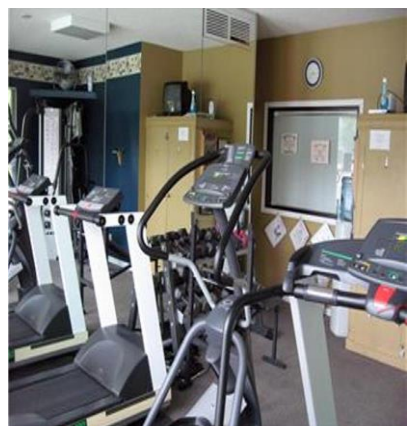

The Farm at Taylor Mill

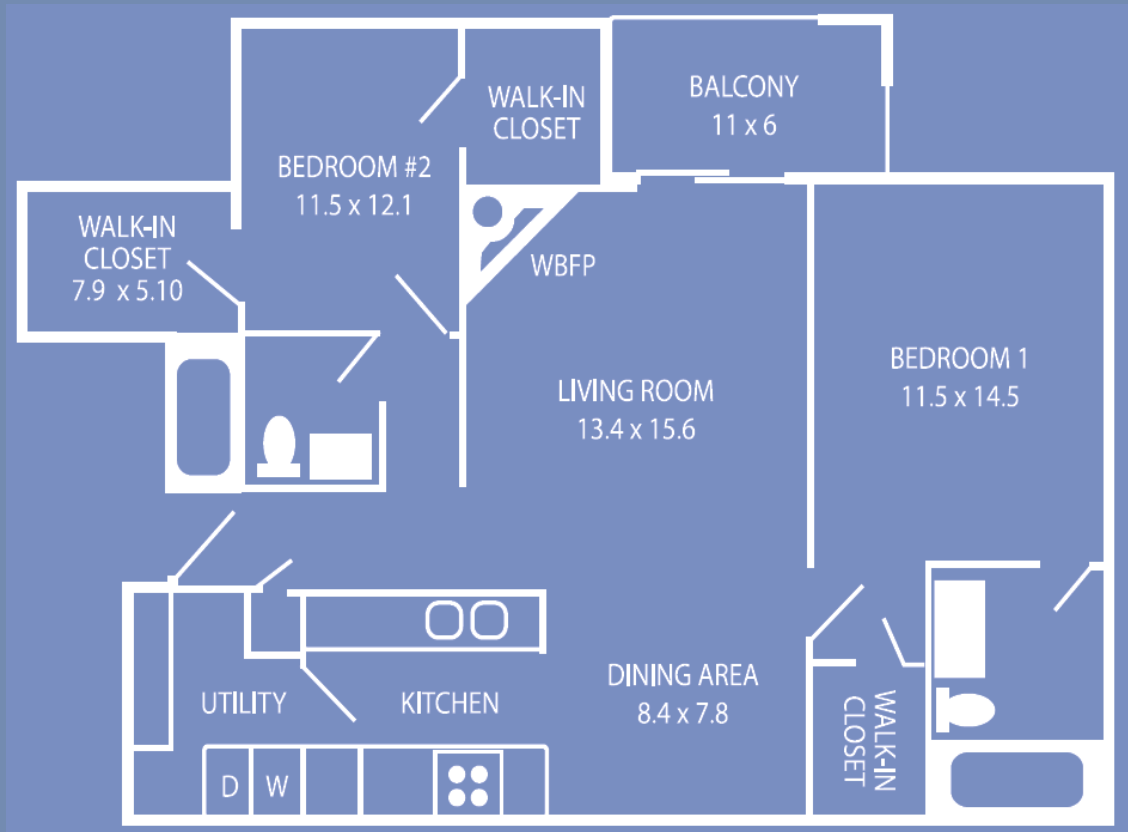

Two Bedroom

1112 Sq. Ft.

Full size washer and dryer included in rent.

1st Floor:

Front View \$
plus same floor storage

Rear View \$
plus third walk-in storage closet

2nd Floor:

Front View \$
plus wood burning fireplace

Rear View \$
plus wood burning fireplace

3rd Floor:

Front View \$
plus cathedral ceiling & skylight

Rear View \$
plus cathedral ceiling & skylight

Security Deposit: \$ 400. for all qualified applicants

Electric: \$ 75. – 125. per month

Application Fee: \$ 25. per application

Water/Sewer: \$ 25. per person per month

Pet Deposit: \$ 150. per pet

Cincinnati Bell or Spectrum

Pet Rent: \$ 25. per pet per month

We want to make The Farm at Taylor Mill your new HOME!